



VIEW OF STUDIO FLOOR FROM GALLERY LEVEL



VIEW OF STUDIO UPSTAGE WALL (WITHOUT DRAPES) W/
10'-0" TALL SCENIC LOADING DOOR

Seating Capacity: 150 (flexible)
Acting Area: 24' deep X 42' wide

Backstage Area (behind drapes): 4'-0"
Height to underside of Grid: 18'-0"

ADDITIONAL CONSIDERATIONS:

- Dressing rooms are located in basement and accessed via a stairwell near the SR exit door.
- CSU Mainstage and Studio theatre spaces share the same loading dock.
- The loading dock is connected to the scene shop and all scenery is loaded through the shop and into the performance venues.
- Loading Dock is at standard dock height with no leveling capabilities.
- Rollup Door from dock into the building is 8'-2". All other scenery doors are 10'-0" tall.
- The loading dock is located partially inside the building behind a large glass roll up door. The theatre loading dock is the glass door located closest to the river.
- Backstage consists of drape that is hung from the underside of the gallery level (not seen in pictures). There are only breaks in the drapes at upstage center, the upstage corners (SL & SR) and at the downstage ends of the drapes.
- The performance configuration will be in a proscenium style with the audience being in tiered seating along the wall where the control booth is located (not pictured).
- The control booth is located on the gallery level and can only be accessed via elevator or stairs.
- **NO HAZE OR FOG OF ANY KIND IS PERMITTED!** It will set off the alarm system.



VIEW FROM ACTING AREA OF STUDIO BOOTH WALL



VIEW FROM ACTING AREA OF STUDIO BOOTH WALL

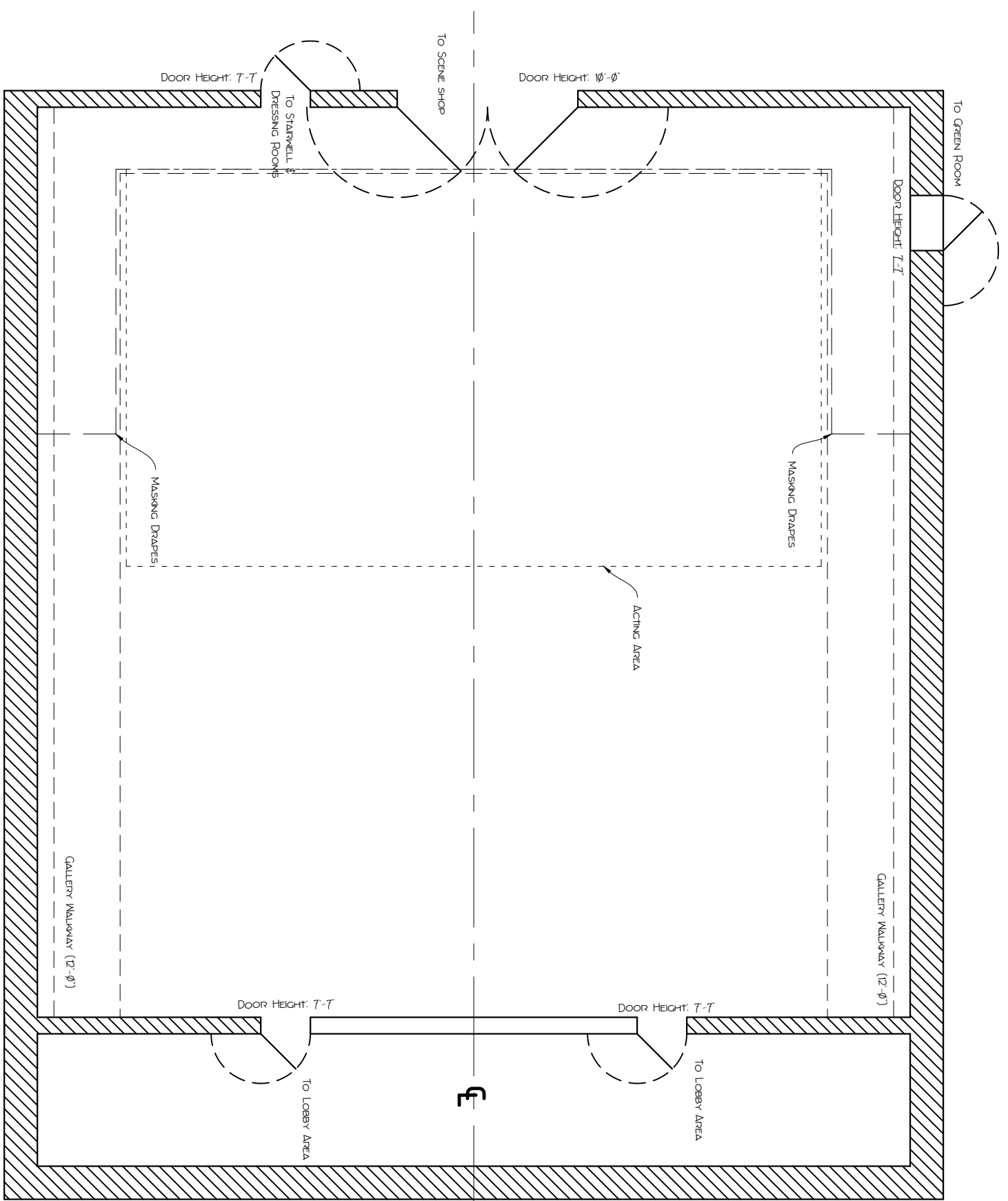

CSU Studio Theatre Ground Plan

Scale: 0'-1/8"=1'-0"